

| 型号<br>Ordering Code |                 |                 | 双通路 固定虹吸管<br>Double passage stationary siphon |                         |     |     |     |      |      |    |     |     |           |    |     |    |        |          |     |   |     |
|---------------------|-----------------|-----------------|---|-------------------------|-----|-----|-----|------|------|----|-----|-----|-----------|----|-----|----|--------|----------|-----|---|-----|
| 水<br>Water          | N               | 水<br>Water      | D   | 空气 - 真空<br>Air & Vacuum | B   | ø D | E   | ø F1 | ø F2 | L  | ø M | ø N | ø P<br>h7 | Q  | R   | S  | T      | U        | V   | W | KG. |
| F10-300-03F-800     | F10-301-03F-800 | F10-302-03F-800 | G 3/8"  | 9                       | 148 | 43  | -   | 82   | 53   | 38 | 18  | 6   | 8         | 9  | 101 | 10 | M6     | G 1/4"   | 1   |   |     |
| F15-300-03F-800     | F15-301-03F-800 | F15-302-03F-800 | G 1/2"  | 13                      | 171 | 55  | -   | 92   | 60   | 45 | 25  | 6   | 10        | 9  | 115 | 12 | G 1/8" | G 3/8"   | 1,7 |   |     |
| F20-300-03F-800     | F20-301-03F-800 | F20-302-03F-800 | G 3/4"  | 18                      | 191 | 64  | -   | 101  | 68   | 50 | 30  | 6   | 10        | 9  | 130 | 14 | G 1/4" | G 1/2"   | 2,4 |   |     |
| F25-300-03F-800     | F25-301-03F-800 | F25-302-03F-800 | G 1"  | 23                      | 217 | 70  | -   | 119  | 78   | 60 | 36  | 7   | 12        | 9  | 157 | 16 | G 3/8" | G 1/2"   | 3   |   |     |
| F32-300-03F-800     | F32-301-03F-800 | F32-301-03F-800 | G 1 1/4"                                      | 31                      | 247 | 85  | 95  | 133  | 94   | 70 | 44  | 8   | 12        | 11 | 172 | 16 | G 1/2" | G 3/4"   | 5,6 |   |     |
| F40-300-03F-800     | F40-301-03F-800 | F40-302-03F-800 | G 1 1/2"                                      | 36                      | 273 | 95  | 105 | 139  | 99   | 78 | 52  | 10  | 14        | 11 | 185 | 18 | G 3/4" | G 1"     | 7,6 |   |     |
| F50-300-03F-800     | F50-301-03F-800 | F50-302-03F-800 | G 2"  | 48                      | 305 | 110 | 120 | 154  | 119  | 95 | 65  | 10  | 14        | 11 | 208 | 20 | G 1"   | G 1 1/4" | 9,5 |   |     |

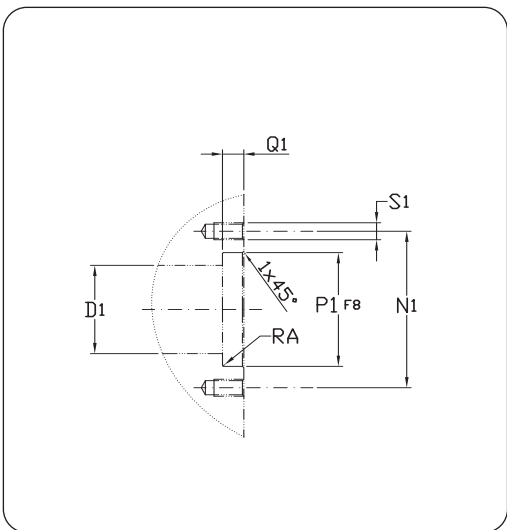

**(CN)** 安装形式

**(UK)** Union Installation

**(D)** Montageanweisungen

**(I)** Istruzioni di montaggio

|     | ø D1 | ø N1 | ø P1 F8 | RA  | Q1 | ø S1      |
|-----|------|------|---------|-----|----|-----------|
| F10 | 9    | 38   | 18      | 0,2 | 6  | M8 4x90°  |
| F15 | 13   | 45   | 25      | 0,2 | 6  | M8 4x90°  |
| F20 | 18   | 50   | 30      | 0,2 | 6  | M8 4x90°  |
| F25 | 23   | 60   | 36      | 0,2 | 7  | M8 4x90°  |
| F32 | 31   | 70   | 44      | 0,2 | 8  | M10 4x90° |
| F40 | 36   | 78   | 52      | 0,2 | 10 | M10 4x90° |
| F50 | 48   | 95   | 65      | 0,2 | 10 | M10 4x90° |